



**MARATHA VIDYA PRASARAK SAMAJ'S**  
**Karmaveer Adv. Baburao Ganpatrao Thakare**  
**College of Engineering (An Autonomous Institute)**



Permanently Affiliated to Savitribai Phule Pune University Vide Letter No. : CA/1542 & Approved by AICTE New Delhi - Vide Letter No. : 740-89-32 (E) ET/98 AISHE Code - C-41622

## SERVER ROOM

**Server Room Photo:**



**Computer Center Lab & Server Room Layout:**

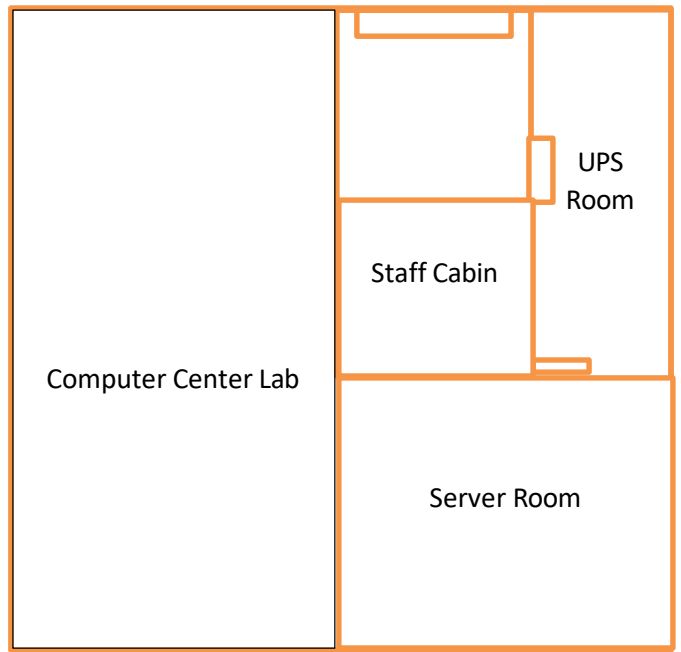

|                          |                         |
|--------------------------|-------------------------|
| <b>Server Room Area:</b> | <b>26.00 Sq. Meters</b> |
|--------------------------|-------------------------|

|                          |                          |  |
|--------------------------|--------------------------|--|
| <b>Server Room Cost:</b> | <b>Rs.1,03,27,059.14</b> | One Crore Three Lakh Twenty Seven Thousand Fifty Nine point One Four |
|--------------------------|--------------------------|--|



**System Analyst**



**System Administrator**

## Major Equipment Available In Server Room

| Sr.no | Name of equipment  | Quantity | Cost        |
|-------|--|----------|-------------|
| 1     | Router 1721 with one 10/100 port & two W/C slots with 1T2 Mbps serial port   | 1        | 49,800.00   |
| 2     | on line UPS 10 KVA   | 1        | 69,230.00   |
| 3     | Dual core Intel Xeon@1.86Ghz, 2 MB L2 Cache 1066Mhz FSB, Intel 3000 server Chipset board, 1GB RAM , Ecc DDR2, 160 GB SATA (Non Hot swap )HDD , DVD-WR , Key board, Optical scroll mouse, 17" LCD/TFT Monitor   | 1        | 52,500.00   |
| 4     | 1)IBM Blade Centre 5 Chain with CA 2*950/450w p50 Recable PN 8886/JA Sr No 599B0171  | 1        | 4,17,500.00 |
|       | 2) Server Connectivity module for IBM blade centre SN 9910358  | 1        |             |
|       | 3)IBM ultra slim enhance SATA multi burner SN 1946M09029908618   | 1        |             |
|       | 4)2.5 " SAS IBM p/n 7870A2A HS22,xeon 4C,E55048000, 2.00Ghz /800Mhz/8MB SN 599M0905-906  | 2        |             |
|       | 5) 2GB Single Rack PC-3 10600 CL9 ECC DDR3 RAM SN 51X010P4/R7/5993/290/294   | 4        |             |
|       | 6) IBM 146GB 10K SAS 2.5" HDD Part No 43007536 SN 59928/69/187/192/255   | 4        |             |
|       | 7)MS Windows 2008 Stand Ed   | 2        |             |
|       | 8) Office Enable kit for Blade Centre 5 Chains   | 1        |             |
| 5     | Cisco Router 1841 Sr.No FWK 142/170NK + WLC IT 1 Port Serial Wan Interface card. Sr.No. FOCI3443JVH + Serial cable   | 1        | 51,712.00   |
| 6     | Sonicwall Network Security Application (NSA 2400)Total Secure for Recommended 220 Concurrent Users )Sonicwall All 24*7 Support With include 10 Global VPN Client Licence(VPN) Feature Services to be integrated with firewall application instruction Detection Prevention System & Getway antivirus Wall premium Content Filtering Services Sonic wall View point for Graphical Reporting Antispyware Application Firewall Layer OS | 1        | 1,30,800.00 |
| 7     | Batteries :- Exide Next (SMF) 12V,65AH   | 16       | 40,000.00   |
| 8     | IBM HS22 Blade server Xeon 4C E5620 80W,2.4 GHz/ 1066 MHz /12MB, 1x4GB,1x300GB,10K Gbps SAS 2.5" SFF slim HS HDD   | 1        | 1,45,200.00 |
| 9     | D-link Load balancer Router DI-LB604   | 1        | 5,550.00    |
| 10    | 01-SSC-3379 Sonicwall Analyzer Reporting Software for NSA 2400 Class Products  | 1        | 12,000.00   |
| 11    | IBM SERVER Blade HS23  | 1        | 1,81,250.00 |
|       | 8 GB Ram   | 3        |             |
|       | 300 GB HDD   | 3        |             |
| 12    | D-link Fiber to UTP Converter singal mode giga DMC 810-SC  | 1        | 12,500.00   |

|    |   |    |             |
|----|---|----|-------------|
| 13 | IBM Server Blade HS23   | 2  | 3,36,600.00 |
|    | 8 GB RAM  | 4  |             |
|    | 300 GB HDD  | 4  |             |
| 14 | Cisco SG-500-28 Layer 3 Switch  | 1  | 1,76,100.00 |
|    | Cisco SG-300-28 Layer 2 Switch  | 2  |             |
|    | 1000 Mbps SFP Module LX Model MBGLX1  | 4  |             |
|    | 42U Rack With Accessories   | 1  |             |
|    | ONE TIME INSTALLATION CHARGES FOR SWITCHES & CONFIGURATION  | 1  |             |
| 15 | Dell Optiplex 3020  | 4  | 1,62,000.00 |
| 16 | Dell Inspiron 15R SE Laptop   | 2  | 1,18,000.00 |
| 17 | Fiber Patch cords   | 8  | 13,040.00   |
| 18 | Techroutes TSR 3800 Router  | 1  | 1,21,000.00 |
| 19 | 1.5 TR Hi-wall Mounted split type air conditioner make-blue star and installation charges for split AC  | 1  | 35,267.00   |
| 20 | 1.5 TR Hi-wall Mounted split type air conditioner make-blue star model no-3HW18JBX Sr no-:IDU-15A01653, ODU-316C01634 and installation charges for split AC | 1  | 35,267.00   |
| 21 | 6 Sq.mm, 3 Core, Copper, FRLS, Flexible Cable   | 92 | 71,690.00   |
|    | Cable Tray 100x50x5mm, perforated GI with cover   | 15 |             |
|    | Power DB - 4 Way TPN Single Door  | 1  |             |
|    | I/C - 63A, 4P, B Curve, 10kA  | 1  |             |
|    | O/G - 32A, 4P, B Curve, 10kA  | 3  |             |
|    | Lugs for 6 Sq.mm Cable, Copper  | 1  |             |
|    | Static Transfer Switch with Switching below 10ms having two incomers and one outgoing and built it surge suppression with Bypass facility                   | 1  |             |
|    | Cable Tie 300mm   | 1  |             |
|    | Rack Mountable Power Distribution Unit of 24 U, 32 A, 7.5 kA with Sockets of IEC 13 and IEC 19, Indicator   | 1  |             |
| 22 | 2.0 Tr Capacity 3 star rating Blue Star split type Air Conditioner  | 1  | 41,300.00   |
| 23 | Electric Timer  | 1  | 4,800.00    |
| 24 | IBM Blade Center S chassis Fan Module   | 4  | 40,120.00   |
| 25 | Lenova Rack Server SR530  | 1  | 3,45,592.00 |
| 26 | Lan tester  | 1  | 796         |
|    | tray 1U   | 3  | 1,593.00    |
|    | cable manager 42 U rack   | 5  | 3,097.00    |
| 27 | D-link 8 port Giga switch   | 1  | 1,850.00    |
| 28 | D-link 8 port 10/100 Mbps switch  | 2  | 1,300.00    |
| 29 | Dell T40 Tower server   | 1  | 69,030.00   |
| 30 | D-link DMC-G1000SC Giga Media converter   | 6  | 33,000.00   |
| 31 | TP Link EAP Higher access point   | 5  | 39,648.00   |
| 32 | D link 8 port switch  | 5  | 8,850.00    |

|                   |  |    |                       |
|-------------------|--|----|-----------------------|
| 33                | Head phone   | 1  | 1,239.00              |
| 34                | CANON DRC scanner  | 1  | 30,680.00             |
| 35                | D-link Access Point 2680 Dueal Band  | 5  | 41,300.00             |
| 36                | Dell power edge Tower Server   | 1  | 54,280.00             |
| 37                | 16 GB RAM  | 1  | 14,042.00             |
| 38                | 24 port POE Switch Gigabit (Hikvision For CCTV Camera)                                   | 5  | 73,160.00             |
| 39                | Slide Pointer  | 1  | 2,324.00              |
| 40                | 2 TB HDD   | 1  | 5,428.00              |
| 41                | Docing Station   | 2  | 2,006.00              |
| 42                | HDMI wirless display dongal Zebronics  | 1  | 1,545.00              |
| 43                | HP SJ Pro 2000S2 Scanner capture the entire document all at once with two side scanning  | 2  | 49,560.00             |
| 44                | Wifi Projector Dongal Punta HTRI   | 2  | 9,204.00              |
| 45                | Media Converter Digisol 1000 Base T Single Fiber Media converter DG MC61235 PT           | 6  | 19,800.00             |
| 46                | Canon Image class LBP 60301B   | 2  | 12,036.00             |
| 47                | 8 Port Giga Switch   | 5  | 7,670.00              |
| 48                | HDMI Splitter 4 Port 4K 60HZ   | 2  | 12,877.34             |
| 49                | Crimping Tool  | 5  | 3,540.00              |
| 50                | TP Link DECO mesh Wifi System 3 in one box   | 12 | 1,58,592.00           |
| 51                | Hikvision NVR D5-7632NIK2 + HDD 4TB Surveillance   | 1  | 21,240.00             |
| 52                | HDMI TO VGA  | 10 | 1,416.00              |
| 53                | PCI Express LAN Card   | 2  | 11,446.00             |
| 54                | Lan tester   | 5  | 4,720.00              |
| 55                | Tricom HDMI to Fiber Audio Converter   | 1  | 10,860.72             |
| 56                | Samsung TV   | 5  | 1,89,906.00           |
| 57                | Projector BenQ   | 1  | 27,575.42             |
| 58                | TP Link EAP Access Point Omada   | 10 | 1,69,920.00           |
| 59                | 24 port Gibit Switch   | 10 | 60,180.00             |
| 60                | Cat 6 Cable Rim  | 5  | 8,637.60              |
| 61                | Richoh fujistu Fi-7600 Scaneer   | 2  | 7,64,640.00           |
| 62                | Matrix Camera  | —  | 65,891.00             |
| 63                | Lenovo Neo50e 24 12SCA114IH Neo 50c 24 GEN , 23.8 FHD , Core i5 , 16GB RAM , 512 SSD M.2 | 76 | 46,40,940.00          |
| 64                | HP Laptop 13th Gen Intel core , i3 Processor , 8GB RAM,512NVME SSD                       | 25 | 10,26,010.00          |
| <b>Total Cost</b> |  |    | <b>1,03,27,059.14</b> |