



MARATHA VIDYA PRASARAK SAMAJ'S
KARMAVEER ADV. BABURAO GANPATRAO THAKARE
COLLEGE OF ENGINEERING



www.kbtcoe.org

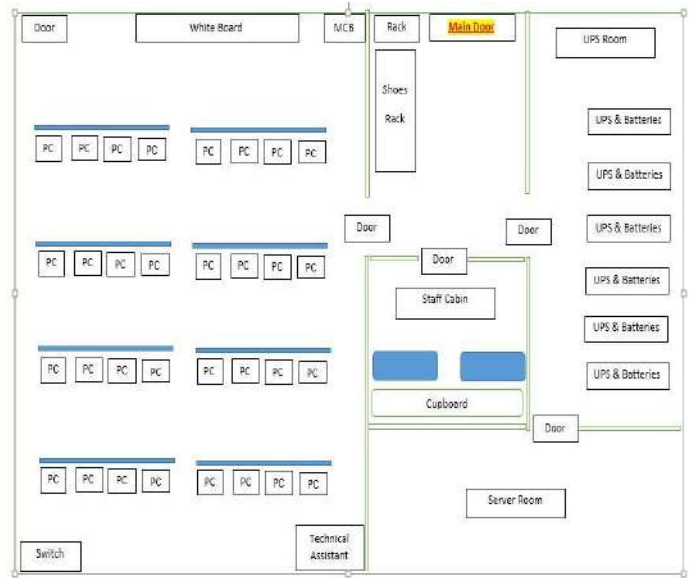

Permanently Affiliated to Savitribai Phule Pune University Vide Letter No: CA/1542
 & Approved by AICTE New Delhi Vide Letter No: 740-89-32 (E) ET/98
 AISHE Code - C-41622

Department of Computer Engineering
Computer Center Laboratory (B-309)



Lab Area:	183.25 Sq. mt.
------------------	-----------------------

Lab Cost:	16,11,216.95 (Sixteen Lakhs Eleven Thousand Two Hundred Sixteen Rupees & Ninty Five Paise Only)
------------------	-------------------------------------------------------------------------------------------------

	
Prof S.V. Pawar Assistant Professor/Lab Incharge	Mr. C.S. Aher Technical Assistant

Major Equipment Available In Lab:

Sr. No.	Name of Equipment / Software	Quantity	Cost
1	DELL: DELL Optiplex 3010CORE-i3 3rd GEN (I3-3220 , 3GHZ,3MB Cache) ,INTEL CHIPSET BOARD,4GB DDR-III RAM,,500 GB SATA @ 7200 RPM Hard Disk, 10/100/1000 Ethernet /MINI-TOWER CABINET/Gigabit / One (1) analog VGA video port, One (1) line in; one (1) line out; one (1) mic in, One (1) RJ-45 network port ,Two (2) front USB ports; Six (6) rear USB ports/Dell Keyboard & Optical Mouse /with DVD RW /With 18.5" LED MONITOR".3 Years Warranty.	3	90,000.00
2	'Make Dell :DELL Optiplex 3020 Minitower Business Desktop (3 Year Warranty): 4th Generation. Intel Core i5-4570Quad Core 3.2 GHz Processor / Intel H61 Chipset Motherboard / 8 GB DDR 3 RAM / 1 TB SATA HDD / DVD Writer / Keyboard & Optical Mouse / Minitower Cabinet/ 18.5" Wide LED Monitor / DOS 2 External USB 3.0 Poart(rear) and 6 External USB 2.0 Port (2 Front , \$rear)/ RJ-45 ; 1 VGA ; 1 Mic-in & 1 Headphone Out(front); 1 Mic-in /Line-in & 1 Line-out (rear), PCI-E Wi-Fi Card, 1 HDMI Port".	15	607,500.00
3	DELL OPTIPLEX-390INTEL CORE I3-2120(3.30GHZ,3MB) INTEL CHIPSET BOARD RAM:-4GB DDR3,500GB 7200 RPM HARD DISK,ONBOARD SOUND, ONBOARD DISPLY, DELL KEYBOARD,DELL OPTICAL SCROLL MOUSE,ONBOARD GIGA LAN PORT,DVD WRITTER,18.5" LED MONITOR DELL	7	197,400.00
5	TOSHIBA SATALITE PRO M200 (E4/30) INTEL CENTRINO DUO TECH ,INTEL CORE 2 DUO @ 1.8 GHZ ,INTEL 965 CHIPSET BOARD,RAM 512MB DDR,HHD 120GB, AGP,SOUND,LAN ON BOARD,USB PORT, WEB CAMMERA , MICRO PHONE, DVD-WR ,WIRELESS,BLUETOOTH,14.1" SCREEN LAPTOP	1	57,900.00
		Total	9,52,800.00

Services Provided:

- 1) Practicals conduction
- 2) Use in Online Exams

Mr. C.S. Aher
Technical Assistant

Ms. S.V. Pawar
Lab Incharge

Dr. D.V. Medhane
Head of Department